

INTEGRAL BATHROOM SPACE

速装自防水整体卫浴空间解决方案

welnest®

广东热浪新材料科技有限公司
地址：广东省珠海市金湾区高栏港经济区精细化工区化联三路13号
NO.13, HUALIAN THIRD ROAD OF FINE CHEMICAL ZONE,
GAOLAN PORT ECONOMIC DEVELOPMENT ZONE,
ZHUHAI CITY, CHINA

电话：400-8221-330 0756-6159089
邮箱：INFO@RELANGTECH.COM
网址：WWW.WELNEST.CN

GUANGDONG RELANG
NEW MATERIAL
TECHNOLOGY CO., LTD

welnest®



INTEGRAL BATHROOM SPACE

QUICK INSTALLATION AND SELF-WATERPROOF
INTEGRAL BATHROOM SPACE SOLUTION

速装自防水整体卫浴空间解决方案

关注医疗环境 创新材料运用 共建绿色医院

*版权属广东热浪新材料科技有限公司，严禁翻版和影印。

*本公司产品已申请中国专利，严禁仿制，违者负法律责任。

*2023年6月印刷

*THE COPYRIGHT BELONGS TO GUANGDONG REHANG NEW MATERIAL TECHNOLOGY CO., LTD.
REPRODUCTION AND PHOTOCOPYING ARE STRICTLY PROHIBITED.

*OUR PRODUCTS HAVE BEEN APPLIED FOR CHINESE PATENTS. COPYING IS STRICTLY PROHIBITED.
VIOLATORS SHALL BEAR LEGAL RESPONSIBILITY.

*PRINTED IN JUNE 2023

广东热浪新材料科技有限公司

地址：广东省珠海市金湾区高栏港经济区精细化工区化联三路13号

NO 13, HUALIAN THIRD ROAD OF FINE CHEMICAL ZONE,
GAOLAN PORT ECONOMIC DEVELOPMENT ZONE, ZHUHAI CITY, CHINA

电话：400-8221-330 0756-6159089

邮箱：INFO@RELANGTECH.COM

网址：WWW.WELNEST.CN

welnest

BATHROOM SPACE SOLUTION

OVERALL
DESIGN

MODULE
PREFABRICATED

STRUCTURAL
WATERPROOF

QUICK
INSTALLATION

整体设计

模块预制

结构防水

快速搭建

WELNEST 卫勒速装自防水整体卫生间以“工厂预制、现场速装”为核心理念，将卫生间的结构“拆解”为不同模块，采用定制化、工厂化预制生产的一体成型底盘、天花和墙体，预装管线，彻底实现“管线分离”。

结合“自主研发胶水 + 卯榫结构”工艺在工地现场进行全干法拼装，呈现超传统手工业的效率 and 品质，并系统集成镜柜、地柜、马桶、淋浴屏、花洒、龙头等各种配套部品，为客户提供优质、高效、平价的卫生间整体解决方案。

WELNEST QUICK INSTALLATION SELF WATERPROOF INTEGRAL BATHROOM TAKES "FACTORY PREFABRICATION AND ON-SITE QUICK INSTALLATION" AS THE CORE CONCEPT, DISASSEMBLES THE BATHROOM STRUCTURE INTO DIFFERENT MODULES, ADOPTS CUSTOMIZED AND FACTORY PREFABRICATED INTEGRATED MOLDING CHASSIS, CEILING AND WALL, AND PRE INSTALLS PIPELINES TO COMPLETELY REALIZE "PIPELINE SEPARATION".

IN COMBINATION WITH THE PROCESS OF "SELF-DEVELOPED GLUE+MORTISE TENON STRUCTURE", THE FULL DRY ASSEMBLY WAS CARRIED OUT ON THE CONSTRUCTION SITE, PRESENTING THE EFFICIENCY AND QUALITY OF ULTRA TRADITIONAL MANUAL OPERATIONS, AND SYSTEMATICALLY INTEGRATING VARIOUS SUPPORTING COMPONENTS SUCH AS MIRROR CABINETS, FLOOR CABINETS, CLOSETS, SHOWER SCREENS, SHOWERS, FAUCETS, TO PROVIDE CUSTOMERS WITH HIGH-QUALITY, EFFICIENT AND AFFORDABLE OVERALL BATHROOM SOLUTIONS.



PART 1 PRODUCT INTRODUCTION

/ 产品介绍

PART 1 产品介绍 02
PRODUCT INTRODUCTION

PART 2 施工要点 15
KEY POINTS OF CONSTRUCTION

PART 3 企业简介 26
PROFILE

PART 4 工程案例 32
PROJECT CASE



SMART STRUCTURE AND FAST ASSEMBLY

结构巧妙 快速拼装

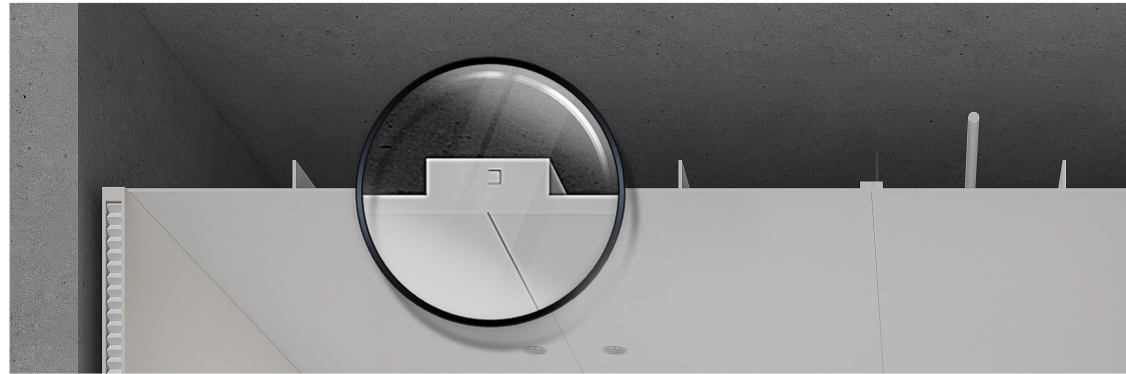

模块设计 卯榫链接
MODULE DESIGN, MORTISE TENON CONNECTION

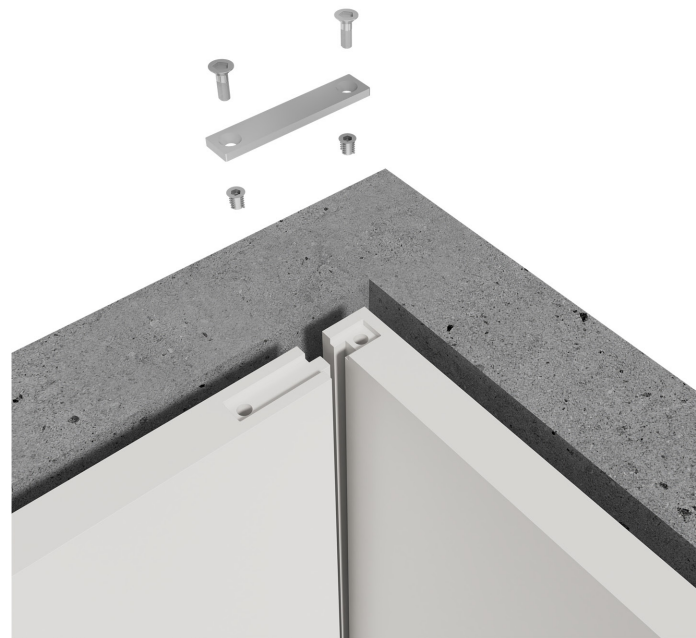

双面卡口设计
BUCKLE DESIGN

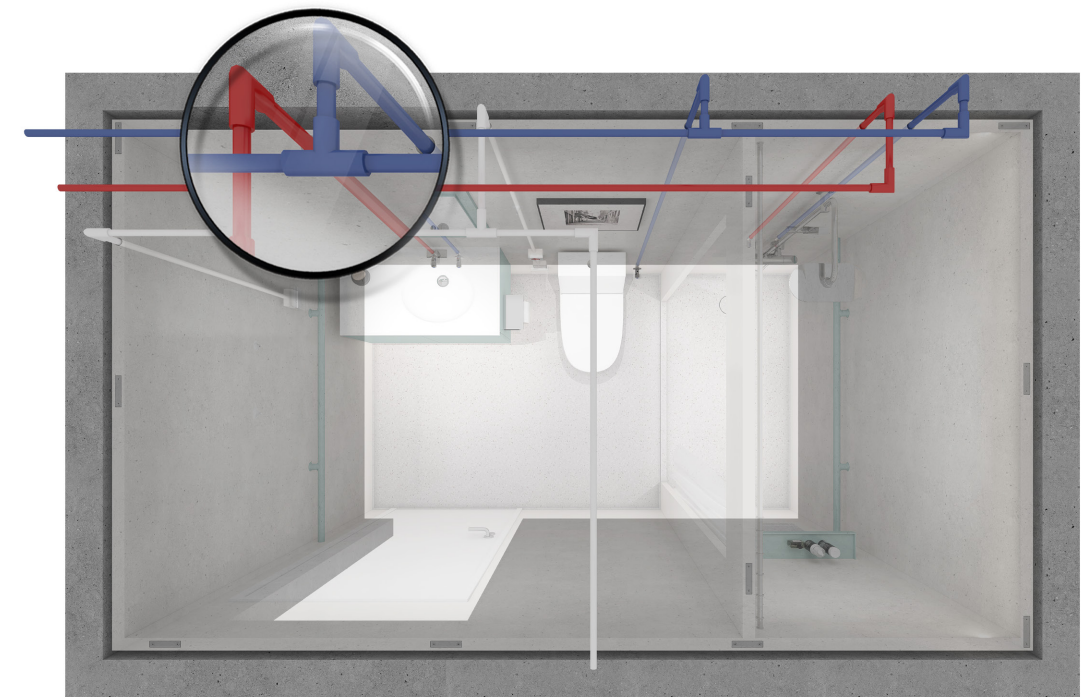

水电内置 稳定可靠
WATER AND ELECTRICITY EMBEDDED, STABLE AND RELIABLE

卫生间模块化设计，分模块工厂预制，水电管线预埋墙体，采用卯榫结构，相邻两个构件上凹凸部位相结合，实现现场配装。

THE BATHROOM IS DESIGNED IN A MODULAR WAY. IT IS PREFABRICATED IN THE FACTORY BY MODULES. THE WATER AND ELECTRICITY PIPELINES ARE EMBEDDED IN THE WALL. THE MORTISE TENON STRUCTURE IS USED. THE CONCAVE AND CONVEX PARTS OF TWO ADJACENT COMPONENTS ARE COMBINED TO ACHIEVE ON-SITE ASSEMBLY.

SMART STRUCTURE AND FAST ASSEMBLY

结构巧妙 快速拼装

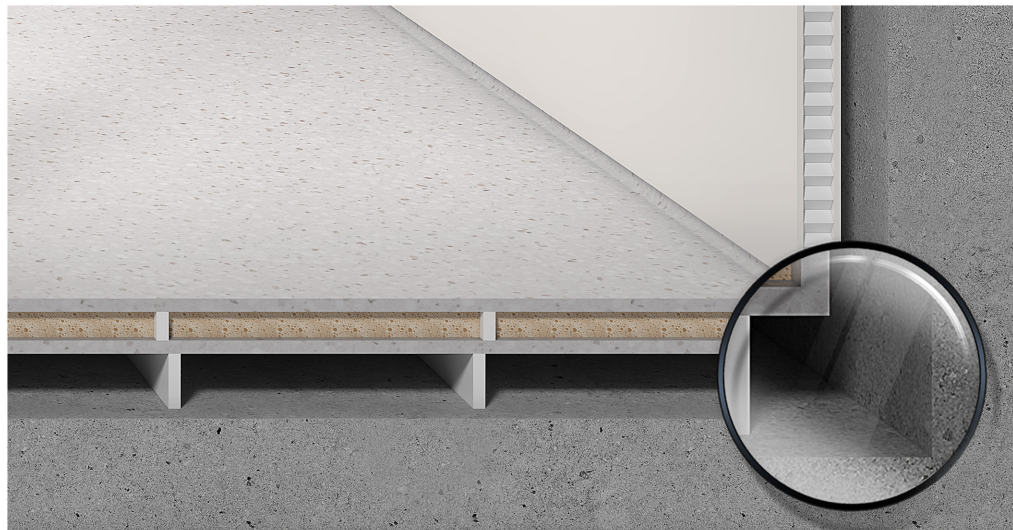

不依附原墙体 尺寸可精确至毫米
NOT ATTACHED TO THE WALL, THE SIZE CAN BE ACCURATE TO MM

现场安装卫生间无需增加龙骨钢框架，实现自支撑承力体系，整体不依附旧墙体，拆装不损伤建筑本身。可二次改造拆迁，可达到抗震7级。

IT IS UNNECESSARY TO ADD KEEL STEEL FRAME TO INSTALL BATHROOM ON SITE TO ACHIEVE A SELF-SUPPORTING LOAD-BEARING SYSTEM, WHICH DOES NOT ATTACH TO THE OLD WALL AS A WHOLE, AND DOES NOT DAMAGE THE BUILDING ITSELF DURING DISASSEMBLY. IT CAN BE RECONSTRUCTED AND RELOCATED FOR THE SECOND TIME, AND CAN REACH EARTHQUAKE RESISTANCE LEVEL 7.

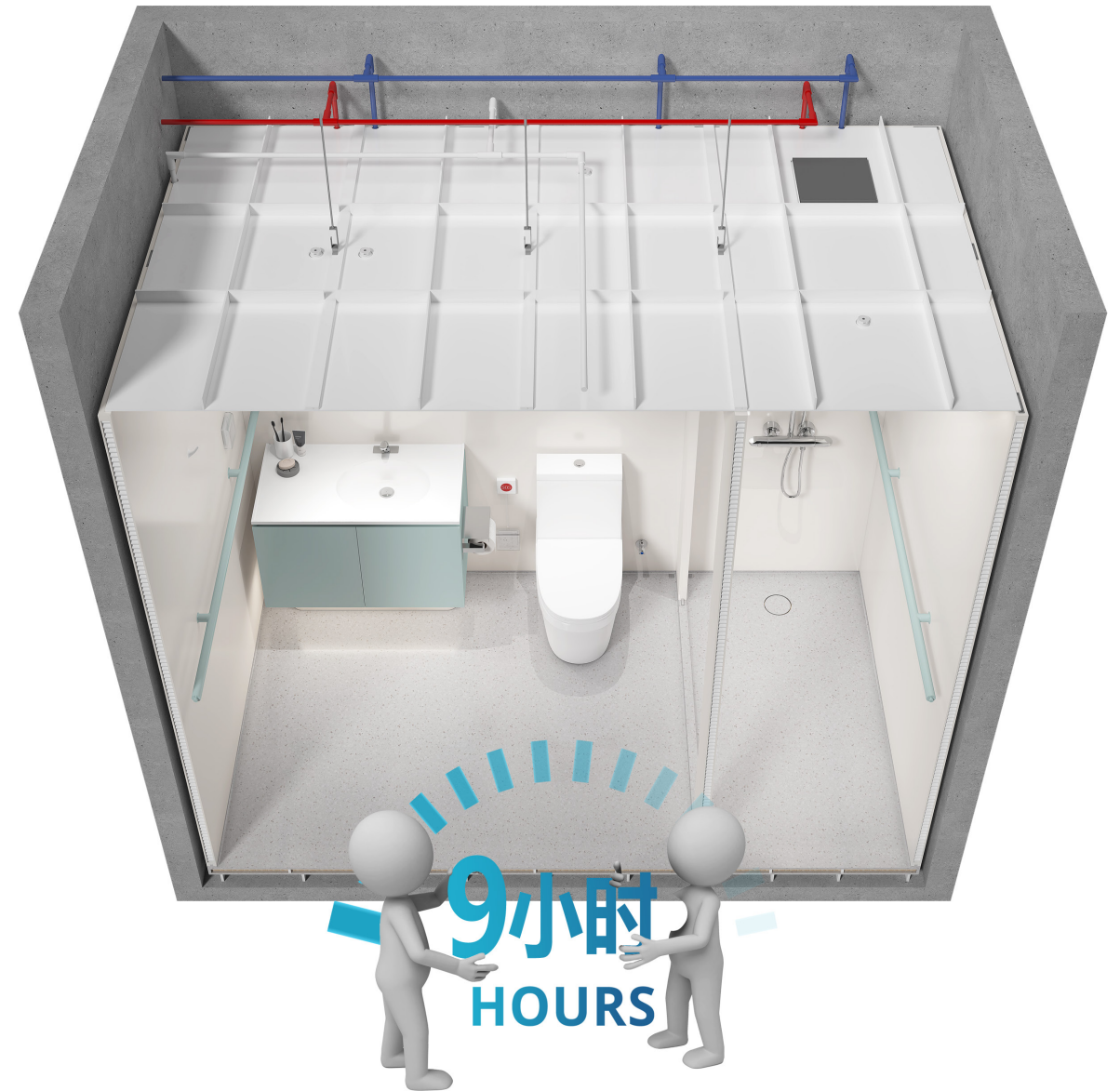

一个卫生间，只需要两个人工，9小时完成搭建全过程。

ONE BATHROOM ONLY REQUIRES 2 WORKERS FOR 9 HOURS TO COMPLETE THE WHOLE PROCESS OF ASSEMBLY.

PRECISE AND STABLE WATERPROOF

精密稳固 全面防水



发泡聚氨酯
与火车枕轨相同填充材料
FOAMED POLYURETHANE
SAME FILLING MATERIAL AS TRAIN SLEEPER



无缝一体化自防水
避免渗漏
SEAMLESS INTEGRATED SELF-WATERPROOF
TO AVOID LEAKAGE



网状/蜂窝结构
稳固减重
MESH/HONEYCOMB STRUCTURE
FOR STABILITY AND WEIGHT REDUCTION



无钢制龙骨框架
自支持承力体系
NO STEEL KEEL FRAME
SELF-SUPPORTING LOAD-BEARING SYSTEM

壁板、天花内含网状/铝蜂窝芯结构，结构稳定，受力科学，卡扣稳固，承重力强。在保留实体面材抑菌防火、隔音、隔热、抗压性能的同时减轻重量。

THE WALL AND CEILING CONTAIN MESH/HONEYCOMB CORE STRUCTURE, WHICH IS STABLE IN STRUCTURE, SCIENTIFIC IN STRESS, STABLE IN NESTING AND STRONG IN BEARING CAPACITY. IT CAN REDUCE THE WEIGHT WHILE RETAINING THE BACTERIOSTATIC, FIREPROOF, SOUND INSULATION, HEAT INSULATION AND COMPRESSIVE PROPERTIES OF SOLID SURFACE MATERIALS.

天花与墙体间卡扣设计, 淋浴地台拥有双层结构排水设计，无缝一体化地台自防水，有效避免卫生间渗漏水。

THE CEILING AND THE WALL HAS A BUCKLE DESIGNED. THE SHOWER PLATFORM HAS A DOUBLE-LAYER STRUCTURE DRAINAGE DESIGN. THE SEAMLESS INTEGRATED PLATFORM IS SELF WATERPROOF, EFFECTIVELY AVOIDING WATER LEAKAGE IN THE TOILET.

POLYMER MATERIALS EXCELLENT PERFORMANCE

高分子材料 性能优异

主要成分：

高品质原料，是一种由亚克力PMMA和特种氢氧化铝粉ATH复合成型的高分子实体面材，符合国际认证标准。

HIGH-QUALITY RAW MATERIALS ARE USED, WITH A PMMA (POLY(METHYL METHACRYLATE)) CONTENT OF OVER 35% AND ATH (ALUMINIUM TRIHYDRATE) SPECIAL POWDER CONTENT EXCEEDING 55%. QUALITY CONTROL IS MAINTAINED FROM THE SOURCE.

无毒害、零甲醛、无挥发、无放射，食品级接触表面，防霉防潮，通过 NSF、CNAS、GREENGUARD (UL) 等多项权威认证。

IT IS NON-TOXIC, FORMALDEHYDE FREE, VOLATILE AND RADIATION FREE, FOOD GRADE CONTACT SURFACE, MILDEW PROOF AND MOISTURE-PROOF, AND HAS PASSED NSF, CNAS, GREENGUARD (UL) AND OTHER AUTHORITATIVE CERTIFICATION.

抗菌抑菌，有效抑制金黄色葡萄球菌、白色念珠菌、大肠杆菌滋生，预防院感，关爱医患健康。

ANTIBACTERIAL AND BACTERIOSTATIC, EFFECTIVELY INHIBIT THE GROWTH OF STAPHYLOCOCCUS AUREUS, CANDIDA ALBICANS, AND ESCHERICHIA COLI, PREVENT HOSPITAL FEELING, AND CARE FOR THE HEALTH OF DOCTORS AND PATIENTS.

可局部修复，可翻新，易维护。

IT CAN BE PARTIALLY REPAIRED, RENOVATED AND EASILY MAINTAINED.

B1级防火，耐火完整性>60MIN

CLASS B1 FIRE PROTECTION, FIRE INTEGRITY>60MIN

无缝拼接技术，弧形边角，不易藏污纳垢、易清洁。

SEAMLESS SPLICING TECHNOLOGY, CURVED CORNERS, NOT EASY TO HIDE DIRT, EASY TO CLEAN.

温润如玉，亲肤质感。

IT IS AS WARM AS JADE AND FEELS CLOSE TO THE SKIN.

材料稳定性高，十五年质保。

HIGH MATERIAL STABILITY, 15 YEAR WARRANTY.



SEAMLESS
无缝拼接



NON TOXIC
无毒环保



NON POROUS
防水不着色



LOW MAINTAIN
维护成本低



ANTI-MICROBIAL
杀菌性能



AIR PURIFYING
净化空气



EASY TO CLEAN
容易清洁



FLEXIBLE TO INSTALL
智慧组合

CURVED CORNER SAFE AND RELIABLE

弧形边角 安全可靠

墙角、地台角部分均使用一体模压成型/无缝圆角接驳技术，安全美观，更易清洁。

THE WALL CORNER AND PLATFORM CORNER ARE ALL EQUIPPED WITH INTEGRATED MOLDING/SEAMLESS FILLET CONNECTION TECHNOLOGY, WHICH IS SAFE, BEAUTIFUL AND EASIER TO CLEAN.



DRAINAGE DESIGN QUICK DRYING

排水设计 急速干爽

精准排水坡度配合材料表面荷叶效应，打造急速干爽的卫浴系统。

PRECISE DRAINAGE SLOPE AND LOTUS LEAF EFFECT ON THE MATERIAL SURFACE CREATE A FAST AND DRY BATHROOM SYSTEM.



可根据现场尺寸定制

实体面材选配配件：台盆、附件。

五金选配市场洁具品牌

CUSTOMIZED ACCORDING TO SITE SIZE

ARTIFICIAL STONE ACCESSORIES: BASIN, ACCESSORIES.

HARDWARE SELECTION MARKET SANITARY WARE BRAND

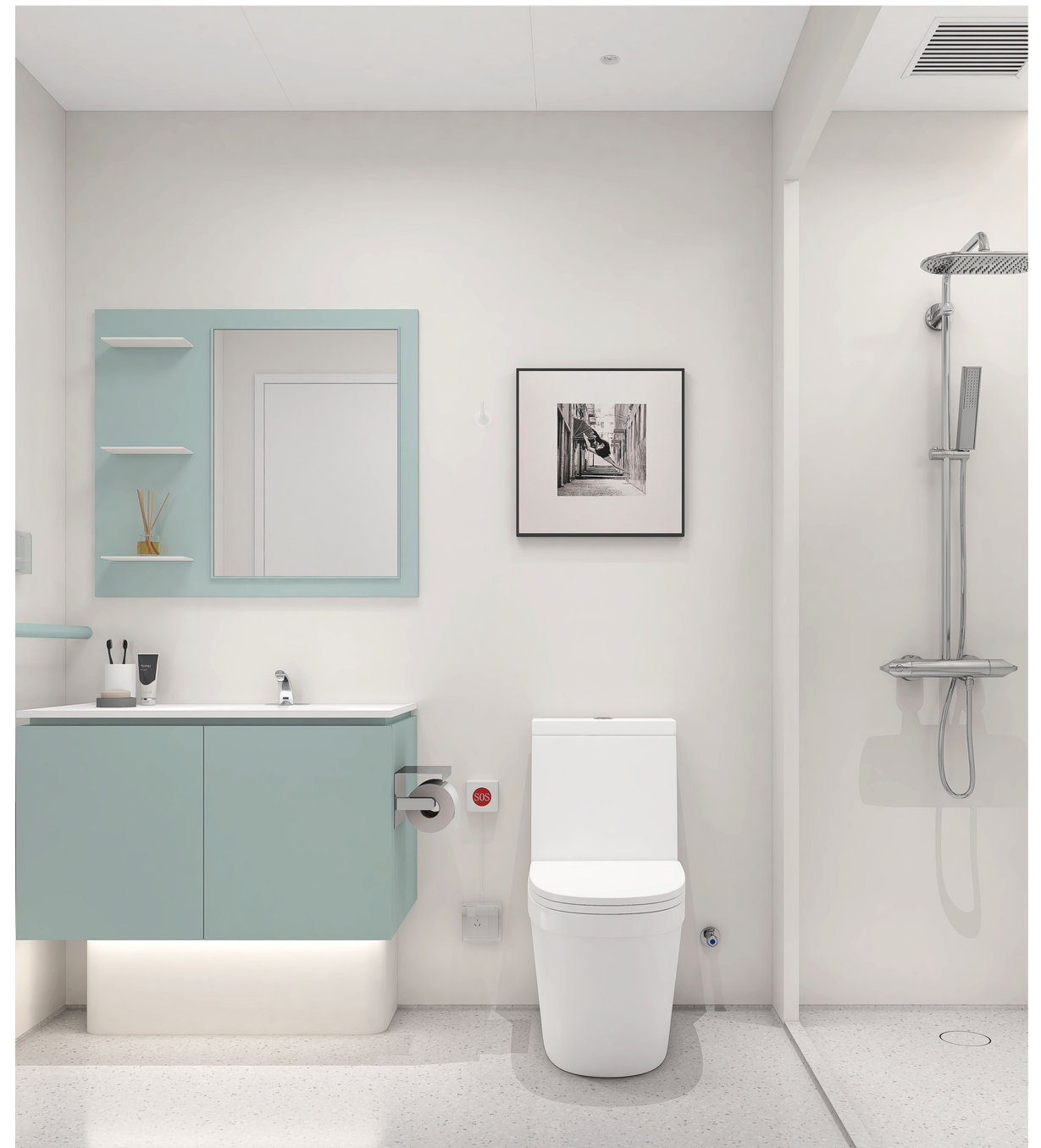

RICH IN CONFIGURATIONS
RICH IN COLOURS
选配丰富 颜色丰富





关爱特殊病患使用，可定制无障碍洗手盆、无障碍淋浴空间。
CARE FOR THE USE OF SPECIAL PATIENTS. ACCESSIBLE WASH BASINS AND SHOWER SPACES CAN BE CUSTOMIZED.

RICH IN CONFIGURATIONS
RICH IN COLOURS

COLOR COLLECTIONS

色彩精选

纯净彩系列（墙面/柜体） PURE COLOR COLLECTION

COLOUR

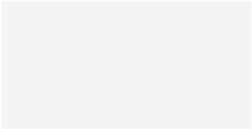

雪白 PM201



银灰 PM128

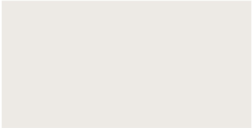

寒酪 PM6260



墨绿 PM6069

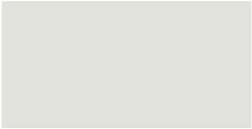

浅淡绿 PM6070



柔黄 PM6140



荔波行舟 PM6193



昙果 PM6213



洋蓝 PM6214



雾淞之恋 PM6235



青雨 PM6240

自然纹理系列（墙面/柜体） NATURAL TEXTURE COLLECTION

TEXTURE



柳纹 PAW066



檀木纹 PAW067



金木纹 PAW076

缤纷颗粒系列（地板） COLORFUL GRAIN SERIES

GRAIN

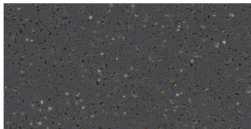

格蕾丝 PM4465



米黄麻 PM4355

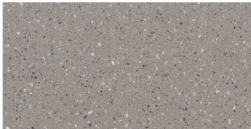

矿境 PM8009

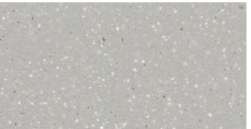

纯灰鸽 PM4290



天灰石 PM4999

*展示存在细微色差，真实颜色以实物样块为准
*THE DISPLAY HAS SLIGHT COLOR DIFFERENCE, AND THE REAL COLOR IS SUBJECT TO THE SAMPLE PIECE

PART 2 KEY POINTS OF CONSTRUCTION

/ 施工要点



1. SITE INSTALLATION CONDITIONS

1. 现场安装条件

量尺要求：

S型蹲便式同层排水沉箱深度要求 ≥ 380 至450MM（根据选样而定）；
隔层排水沉箱深度要求 ≥ 260 至320MM（根据选样而定）。

THE DEPTH OF S-TYPE SQUATTING TYPE DRAINAGE CAISSON ON THE SAME FLOOR IS REQUIRED TO BE ≥ 380 TO 450MM (DEPENDING ON THE SAMPLE SELECTION);

THE DEPTH OF THE COMPARTMENT DRAINAGE CAISSON IS REQUIRED TO BE ≥ 260 TO 320MM (DEPENDING ON THE SAMPLE SELECTION).

坐便式同层排水沉箱深度要求 ≥ 180 MM；隔层排水沉箱深度要求 ≥ 60 MM。

THE DEPTH OF TOILET TYPE DRAINAGE CAISSON ON THE SAME FLOOR SHALL BE ≥ 180 MM; THE DEPTH OF THE COMPARTMENT DRAINAGE CAISSON SHALL BE ≥ 60 MM.

墙地面要求滚涂防水两遍，墙面防水高度为1000MM。

THE WALL AND FLOOR SHALL BE ROLLER COATED TWICE FOR WATERPROOFING, AND THE WALL WATERPROOF HEIGHT SHALL BE 1000MM.

冷、热水、排水、消防、排风管道（风口）、门及门套到位。

COLD WATER, HOT WATER, DRAINAGE, FIRE PROTECTION, AIR EXHAUST PIPE (AIR OUTLET), DOOR AND DOOR POCKET SHALL BE IN PLACE.

安全电路电线：照明线路、换气线路、插座线路、开关线路、等电位。

SAFETY CIRCUIT WIRES: LIGHTING LINES, AIR EXCHANGE LINES, SOCKET LINES, SWITCH LINES, EQUIPOTENTIAL LINES.

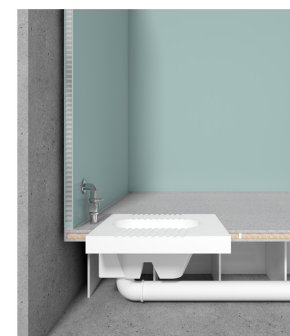

蹲便同层排水

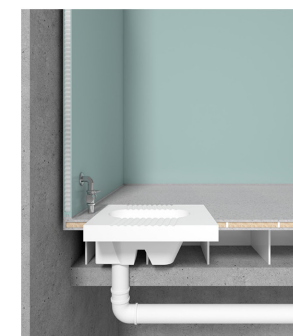

蹲便异层排水



坐便同层排水



坐便异层排水

2. WALL PANEL INSTALLATION

2. 墙板安装

根据图纸及卯榫结构顺序安装墙板，完成一块立即锁定墙板顶部铝制锁扣件，使自然接缝紧密、平整，公榫阴角处无间断打白防霉结构胶防止渗漏。

INSTALL THE WALLBOARD ACCORDING TO THE DRAWINGS AND THE ORDER OF MORTISE AND TENON STRUCTURE, AND IMMEDIATELY LOCK THE ALUMINUM LOCK FASTENER ON THE TOP OF THE WALLBOARD TO MAKE THE NATURAL JOINT TIGHT AND FLAT, AND APPLY PORCELAIN WHITE MOLD PROOF GLASS GLUE AT THE INTERNAL CORNERS OF THE MALE TENON WITHOUT INTERRUPTION TO PREVENT LEAKAGE.

等电位与冷水出口件三色铜芯电源线相连接，固定牢固、不外漏。

THE EQUIPOTENTIAL IS CONNECTED WITH THE THREE COLOR COPPER CORE POWER CORD OF THE COLD WATER OUTLET PIECE, AND IS FIRMLY FIXED WITHOUT LEAKAGE.

窗套侧板与建筑墙体之间为结构胶200MM间距打点连接，保持横平竖直，侧板与窗框接口缝隙为白色防霉玻璃胶收口，胶面顺直、不空胶、不溢胶。

THE STRUCTURAL GLUE SHALL BE USED FOR DOT CONNECTION BETWEEN THE SIDE PANEL OF THE WINDOW SLEEVE AND THE BUILDING WALL AT A SPACING OF 200MM TO KEEP IT HORIZONTAL AND VERTICAL. THE GAP BETWEEN THE SIDE PANEL AND THE WINDOW FRAME SHALL BE CLOSED WITH WHITE MOLD PROOF GLASS GLUE, AND THE GLUE SURFACE SHALL BE STRAIGHT, FREE OF EMPTY GLUE AND OVERFLOW GLUE.

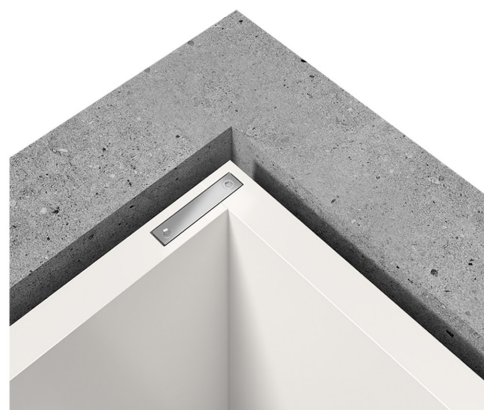

墙板与墙板连接点1



墙板与墙板连接点2



墙板与门头板连接点

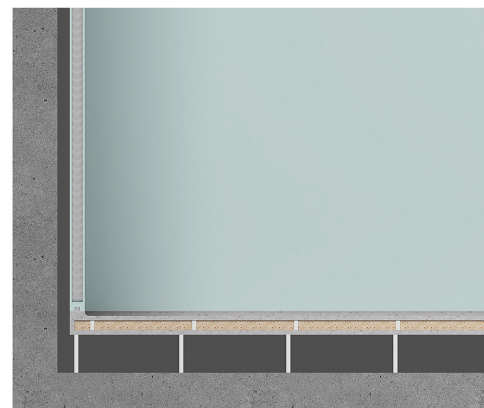

墙板与地台连接点

3. WATER LINE/ELECTRIC CIRCUIT INSTALLATION

3. 顶部水/电路安装

将预留的给水管口、电路端口连接卫生间墙板的预留接口。

预留水电位，高度高于卫生间天花完成面200MM。

CONNECT THE RESERVED WATER SUPPLY PIPE ORIFICE AND CIRCUIT PORT TO THE RESERVED INTERFACE OF THE BATHROOM WALL PANEL. RESERVE WATER POTENTIAL, WITH A HEIGHT 200MM HIGHER THAN THE FINISHED SURFACE OF THE BATHROOM CEILING.

顶部给水管采用PP-R或不锈钢饮用水管连接，外套消音软绵管；线路采用阻燃套管穿线，整体牢固，接头不松动。

THE TOP WATER SUPPLY PIPE IS CONNECTED WITH PP-R OR STAINLESS STEEL DRINKING PIPE, AND IS COVERED WITH MUFFLED SOFT COTTON PIPE; THE LINE SHALL BE THREADED WITH FLAME RETARDANT CASING, WHICH SHALL BE FIRM AS A WHOLE AND THE JOINT SHALL NOT BE LOOSE.

冷热给水管试压标注为8MPa, 上压30分钟以后查看压力表无掉压、管接头无渗漏为标准。

THE PRESSURE TEST MARK OF COLD AND HOT WATER SUPPLY PIPES IS 8MPA. AFTER 30 MINUTES OF PRESSURIZATION, CHECK THAT THE PRESSURE GAUGE IS FREE OF PRESSURE DROP AND THE PIPE JOINT IS FREE OF LEAKAGE.



4. PLATFORM POSITIONING AND INSTALLATION

4. 地台定位、安装：（安装前确认好门套宽度）

高度定位：清理地面，地台高度定位以现场一米水平线为基准线，一米线下口线为门槛石上口定位地台高度，水平度误差≤1MM。

HEIGHT POSITIONING: CLEAR THE GROUND, TAKE THE ONE METER HORIZONTAL LINE OF THE SITE AS THE REFERENCE LINE FOR PLATFORM HEIGHT POSITIONING, AND THE LOWER LINE OF THE ONE METER LINE IS THE HEIGHT OF THE POSITIONING PLATFORM AT THE UPPER ENTRANCE OF THE THRESHOLD STONE, WITH THE LEVELNESS ERROR ≤ 1MM.

地台平面定位： PLATFORM POSITIONING:

双包门套地台定位：左右定位以地台门槛的长度中心线对准成品门套的宽度正方中心线为准。

PLATFORM POSITIONING OF DOUBLE ENVELOPING DOOR JAMB: THE LEFT AND RIGHT POSITIONING SHALL BE SUBJECT TO THE ALIGNMENT OF THE LENGTH CENTERLINE OF THE PLATFORM SILL WITH THE SQUARE CENTERLINE OF THE WIDTH OF THE FINISHED DOOR JAMB.

前后定位以成品门套内脸凸出地台围边内口12MM为准。

THE FRONT AND REAR POSITIONING SHALL BE SUBJECT TO THAT THE INNER FACE OF THE FINISHED DOOR POCKET PROTRUDES 12MM FROM THE INNER OPENING OF THE PLATFORM PERIMETER.

单包门套（外包）地台定位：左右定位以地台门槛的长度中心线对准成品门套的宽度正方中心线为准。

前后定位以地台门口边线离建筑墙体30MM为准。

POSITIONING OF SINGLE PACKAGE DOOR JAMB (OUTSOURCING) PLATFORM: THE LEFT AND RIGHT POSITIONING SHALL BE SUBJECT TO THE ALIGNMENT OF THE LENGTH CENTERLINE OF THE PLATFORM SILL WITH THE SQUARE CENTERLINE OF THE WIDTH OF THE FINISHED DOOR JAMB.THE FRONT AND REAR POSITIONING SHALL BE SUBJECT TO 30MM FROM THE SIDELINE OF THE PLATFORM DOORWAY TO THE BUILDING WALL.

排水管道铺设：

同层排水根据设计方案提前铺设排水管到。

隔层排水根据设计方案孔位图及孔径大小，预先钻好下通管道孔。

LAYING OF DRAINAGE PIPES:

THE DRAINAGE PIPES ON THE SAME FLOOR SHALL BE LAID IN ADVANCE ACCORDING TO THE DESIGN SCHEME.

ACCORDING TO THE HOLE LOCATION AND APERTURE SIZE OF THE DESIGN SCHEME, THE HOLE FOR THE DOWN PIPE SHALL BE DRILLED IN ADVANCE FOR THE COMPARTMENT DRAINAGE.

网格垫框安装：地台底面与建筑地面之间超过100MM距离时安装网格垫框，保证地台稳固性和承重力。

INSTALLATION OF GRID CUSHION FRAME: WHEN THE DISTANCE BETWEEN THE BOTTOM OF THE PLATFORM AND THE BUILDING GROUND EXCEEDS 100MM, GRID CUSHION FRAME SHALL BE INSTALLED TO ENSURE THE STABILITY AND BEARING CAPACITY OF THE PLATFORM.

*安装前确认好门套宽度

*CONFIRM THE DOOR POCKET WIDTH BEFORE INSTALLATION

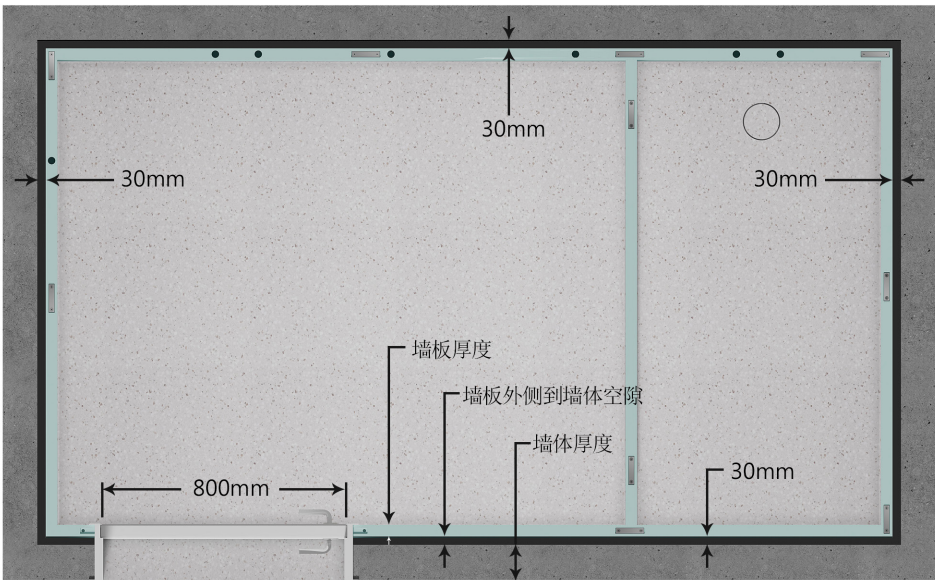
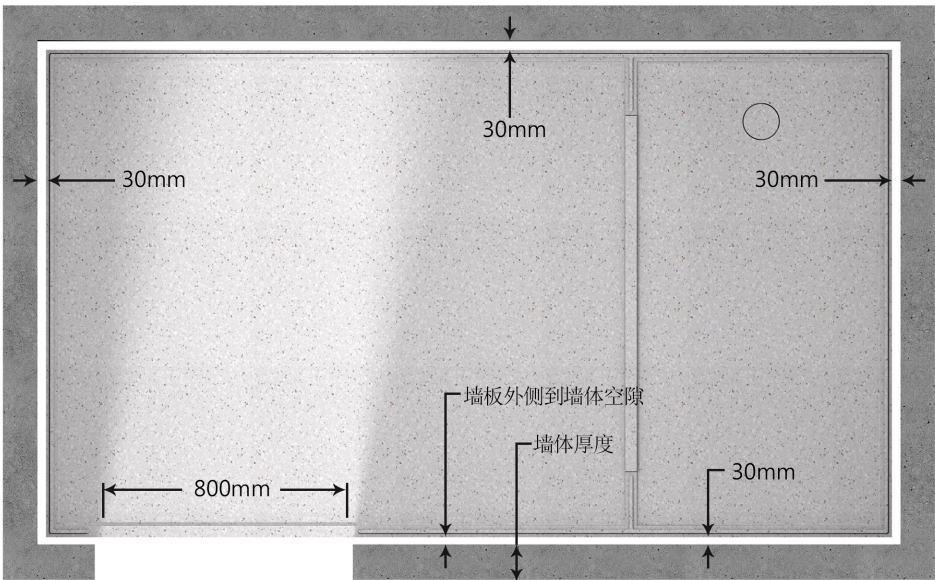
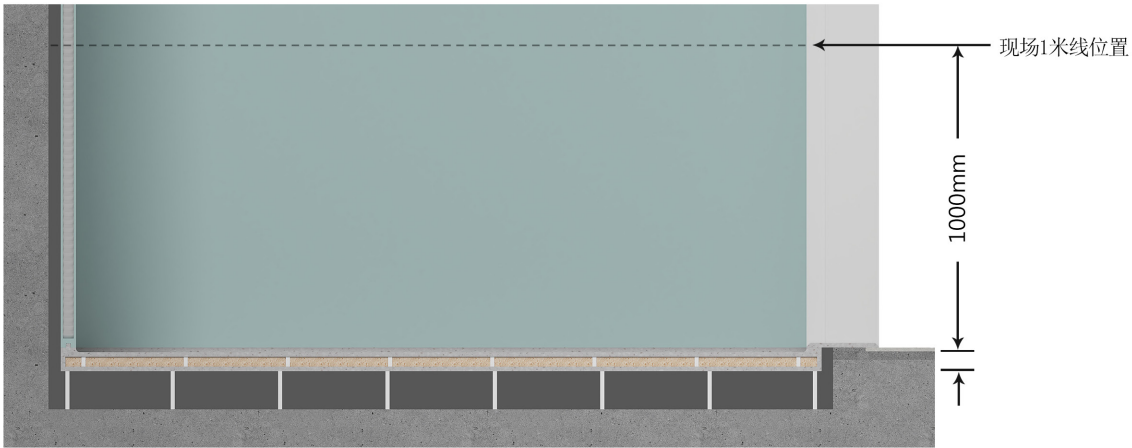

5. TOP PLATE INSTALLATION

5. 顶板安装

板与板之间卯榫自然拼接，螺丝将顶板锁定于墙板，顶板中间位置采用吊挂式调节螺杆调平固定。

THE MORTISE AND TENON BETWEEN PLATES ARE NATURALLY SPLICED. THE SCREWS LOCK THE TOP PLATE TO THE WALLBOARD. THE MIDDLE POSITION OF THE TOP PLATE IS LEVELED AND FIXED WITH A HANGING ADJUSTING SCREW.

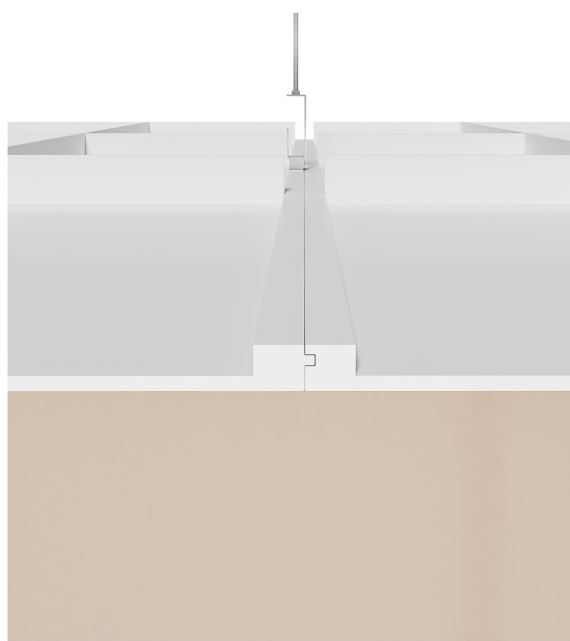

天花与天花连接点1



天花与天花连接点2



天花与墙板连接点1



天花与墙板连接点2

6. INSTALLATION OF WASH BASIN

6. 洗手台安装



按图示位置安装铁架（要求螺丝拧紧到位，平面水平），洗手台面（先调平后，铁架与台面打玻璃胶粘结）、与墙板连接处人造石胶胶结；玻璃镜子挂好后，左右角点玻璃胶固定。

INSTALL THE IRON FRAME ACCORDING TO THE POSITION SHOWN IN THE FIGURE (THE SCREWS ARE REQUIRED TO BE TIGHTENED IN PLACE AND THE PLANE IS HORIZONTAL), THE HAND WASHING TABLE TOP (AFTER LEVELING, THE IRON FRAME AND THE TABLE TOP ARE BONDED WITH GLASS GLUE), AND THE ARTIFICIAL STONE GLUE AT THE CONNECTION WITH THE WALL PANEL; AFTER THE GLASS MIRROR IS HUNG, FIX IT WITH GLASS GLUE AT THE LEFT AND RIGHT CORNERS.

7. INSTALLATION OF HARDWARE, SANITARY WARE, LAMPS AND ELECTRICAL APPLIANCES

7. 五金、洁具、灯具、电器安装

包括龙头、三角阀、肥皂架、淋浴混水阀、花洒、下水软管、筒灯、换气扇等。

INCLUDING FAUCET, TRIANGLE VALVE, SOAP HOLDER, SHOWER MIXING VALVE, SHOWER, SEWER HOSE, DOWNLIGHT, VENTILATOR, ETC.



8. INSTALLATION OF THRESHOLD STONE

8. 门槛石安装

门槛石内口与地台卯榫相连，
外口与门框平齐、水平安装。

THE INNER OPENING OF THE THRESHOLD STONE IS CONNECTED WITH THE MORTISE AND TENON OF THE PLATFORM, AND THE OUTER OPENING IS FLUSH WITH THE DOOR FRAME AND INSTALLED HORIZONTALLY.



MAINTENANCE

维护保养

产品的使用、维护保养

MAINTENANCE OF PRODUCTS

为了实现最佳性能，保养产品时请注意以下几点：
可使用抹布或百洁布蘸取温和的试剂擦拭
可使用魔术擦轻轻擦除

IN ORDER TO ACHIEVE THE BEST PERFORMANCE, PLEASE PAY ATTENTION TO THE FOLLOWING POINTS WHEN MAINTAINING THE PRODUCT:
WIPE WITH A RAG OR CLEANING CLOTH DIPPED WITH MILD REAGENT
IT CAN BE GENTLY ERASED WITH A MAGIC ERASER.

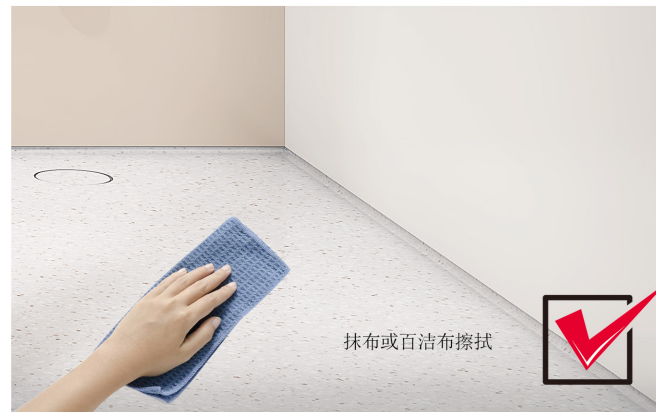

勿使用尖锐利器刮擦表面，以免擦伤
勿使用强酸、强碱性清洁剂来清洁

DO NOT USE SHARP TOOLS TO SCRATCH THE SURFACE TO AVOID SCRATCHES.
DO NOT USE STRONG ACID OR ALKALINE CLEANER TO CLEAN.



PART 3

PROFILE

/ 企业简介

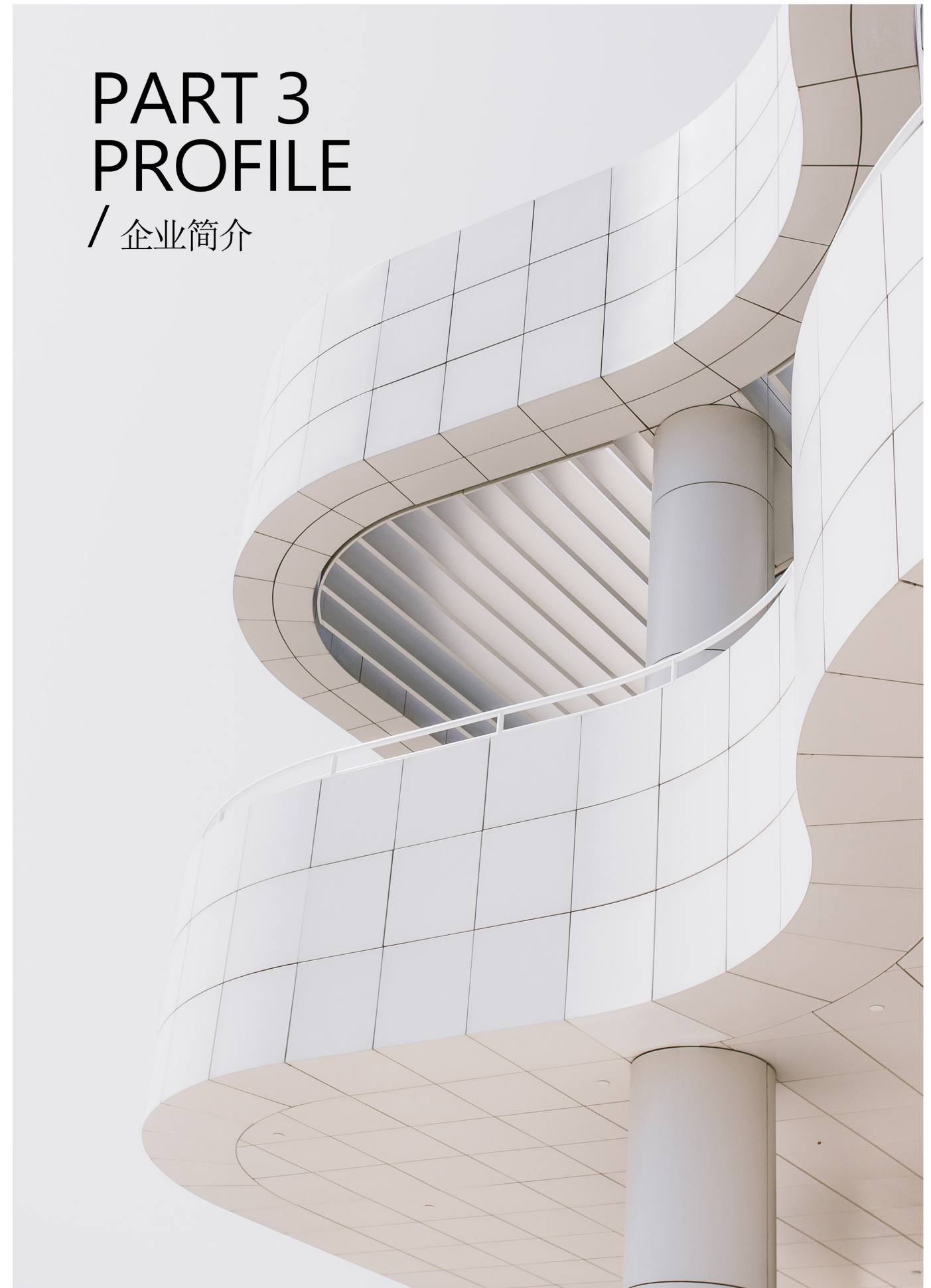



DESIGN AND R&D

设计研发

遵循全球最成熟理念、结合全球先进材质、工艺，集结国内资深卫浴研发团队，针对中国医院建设和卫生间使用习惯及市场需求，进行适应性改进，系统性开发。从结构可靠、空间合理、功能舒适、安全环保四大系统入手研发设计。

ADHERING TO THE WORLD'S MOST MATURE CONCEPT, COMBINED WITH THE WORLD'S ADVANCED MATERIALS AND PROCESSES, WE HAVE ASSEMBLED A SENIOR DOMESTIC BATHROOM RESEARCH AND DEVELOPMENT TEAM TO MAKE ADAPTIVE IMPROVEMENT AND SYSTEMATIC DEVELOPMENT FOR CHINESE HOSPITAL CONSTRUCTION, BATHROOM USE HABITS AND MARKET DEMAND. THE R&D AND DESIGN STARTS FROM FOUR SYSTEMS: RELIABLE STRUCTURE, REASONABLE SPACE, COMFORTABLE FUNCTION, SAFETY AND ENVIRONMENTAL PROTECTION.

PRODUCTION

产品生产

100亩生产基地确保产能

广东热浪新材料科技有限公司成立于1999年，是一家专注于高分子新型实体面材的高新技术企业。拥有全世界最先进的实体面材生产设备，先后参与起草制定国内实体面材、非陶瓷类洁具的行业标准，在 高分子实体面材的研发、生产、加工、安装方独具优势，生产基地园区占地面积100亩。高分子实体面材板材生产能力120万片/年，卫浴产品生产能力10万件/年，整装式卫浴空间、医疗家具约3万件/年。交期、运输成本和产能实现最大优化。

67000 SQUARE METERS OF PRODUCTION BASE TO ENSURE PRODUCTION CAPACITY

GUANGDONG REHANG NEW MATERIAL TECHNOLOGY CO., LTD., FOUNDED IN 1999, IS A HIGH-TECH ENTERPRISE FOCUSING ON NEW POLYMER SOLID SURFACE MATERIALS. IT HAS THE MOST ADVANCED SOLID SURFACE MATERIAL PRODUCTION EQUIPMENT IN THE WORLD, HAS PARTICIPATED IN DRAFTING AND FORMULATING THE INDUSTRIAL STANDARDS FOR DOMESTIC SOLID SURFACE MATERIALS AND NON CERAMIC SANITARY WARES, AND HAS UNIQUE ADVANTAGES IN THE R&D, PRODUCTION, PROCESSING AND INSTALLATION OF POLYMER SOLID SURFACE MATERIALS. THE PRODUCTION BASE COVERS AN AREA OF 100 MU. THE PRODUCTION CAPACITY OF POLYMER SOLID SURFACE MATERIALS IS 1.2 MILLION PIECES/YEAR, THE PRODUCTION CAPACITY OF SANITARY PRODUCTS IS 100000 PIECES/YEAR, AND THE PRODUCTION CAPACITY OF PACKAGED SANITARY SPACES AND MEDICAL FURNITURE IS ABOUT 30000 PIECES/YEAR. THE DELIVERY TIME, TRANSPORTATION COST AND CAPACITY ARE OPTIMIZED TO THE MAXIMUM.

现代化工厂精益生产

工厂通过项目管理及JIT生产模式，在限定时间内高效、高质完成生产，同时还能全面质量管控，消除不合格品；通过QCC品质改善活动圈，积极发现并持续不断的改善问题，力争让产品出厂合格率达到100%。

LEAN PRODUCTION IN MODERN PLANTS

THROUGH PROJECT MANAGEMENT AND JIT PRODUCTION MODE, THE FACTORY CAN COMPLETE THE PRODUCTION WITH HIGH EFFICIENCY AND QUALITY WITHIN A LIMITED TIME, AND AT THE SAME TIME, IT CAN CONDUCT OVERALL QUALITY CONTROL TO ELIMINATE UNQUALIFIED PRODUCTS; THROUGH THE QCC QUALITY IMPROVEMENT ACTIVITY CIRCLE, ACTIVELY FIND AND CONTINUOUSLY IMPROVE PROBLEMS, AND STRIVE TO MAKE THE FACTORY PASS RATE OF PRODUCTS REACH 100%.

自动化生产线高效生产

拥有全球实体面材领域内最先进的生产系统，通过 DCS 计算系统实现了自动化生产，是国内唯一一家拥有全进口自动化钢带连续浇注能力的生产企业。率先在医疗家具产品中引用高智能机器人自动生产线，实现自动化的大批量定制生产。可 24 小时不间断作业，提高生产效率。无喷涂环节，减少环境污染。

AUTOMATIC PRODUCTION LINE FOR EFFICIENT PRODUCTION

IT HAS THE MOST ADVANCED PRODUCTION SYSTEM IN THE FIELD OF SOLID SURFACE MATERIALS IN THE WORLD, AND HAS REALIZED AUTOMATIC PRODUCTION THROUGH DCS COMPUTING SYSTEM. IT IS THE ONLY MANUFACTURER IN CHINA THAT HAS THE CONTINUOUS CASTING CAPACITY OF FULLY IMPORTED AUTOMATIC STEEL STRIPS. TAKE THE LEAD IN INTRODUCING HIGH INTELLIGENT ROBOT AUTOMATIC PRODUCTION LINE IN MEDICAL FURNITURE PRODUCTS TO REALIZE AUTOMATIC MASS CUSTOMIZATION PRODUCTION. IT CAN WORK 24 HOURS WITHOUT INTERRUPTION TO IMPROVE PRODUCTION EFFICIENCY. NO SPRAYING PROCESS, REDUCING ENVIRONMENTAL POLLUTION.



全程品质管控

设计-研发-采购-生产-物流-安装-售后

严格遵循ISO9001标准并借鉴APPLE的品质管理模式，从设计审查、产品验证到售后服务，建立全过程的流程化监控体系。全面品保，全员参与，建立持续改善的品质文化！

WHOLE PROCESS QUALITY CONTROL

DESIGN - R&D - PURCHASE - PRODUCTION - LOGISTICS - INSTALLATION - AFTER-SALES

STRICTLY FOLLOW ISO9001 STANDARD AND LEARN FROM APPLE'S QUALITY MANAGEMENT MODE TO ESTABLISH A WHOLE PROCESS FLOW MONITORING SYSTEM FROM DESIGN REVIEW, PRODUCT VERIFICATION TO AFTER-SALES SERVICE. COMPREHENSIVE QUALITY ASSURANCE, FULL PARTICIPATION, AND THE ESTABLISHMENT OF A QUALITY CULTURE OF CONTINUOUS IMPROVEMENT!

TECHNICAL SERVICE

技术服务

完善的技术服务是产品交付的重中之重
PERFECT TECHNICAL SERVICE IS THE TOP PRIORITY OF PRODUCT DELIVERY

整装卫浴作为新兴概念，市场认知有限，因此，专业而强大的技术服务团队是项目成功的关键要素。5年以上的专业技术服务团队，形成了一套完善的技术支持逻辑和作业指导，确保每个项目的顺利落地。

AS AN EMERGING CONCEPT, THE MARKET COGNITION OF THE INTEGRAL BATHROOM IS LIMITED. THEREFORE, A PROFESSIONAL AND STRONG TECHNICAL SERVICE TEAM IS THE KEY FACTOR FOR THE SUCCESS OF THE PROJECT.

THE PROFESSIONAL TECHNICAL SERVICE TEAM OF MORE THAN 5 YEARS HAS FORMED A COMPLETE SET OF TECHNICAL SUPPORT LOGIC AND OPERATION GUIDANCE TO ENSURE THE SMOOTH IMPLEMENTATION OF EACH PROJECT.

技术服务核心内容

CORE CONTENT OF TECHNICAL SERVICES

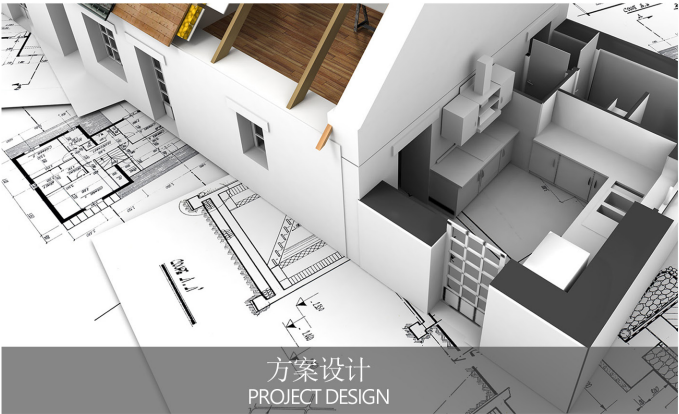

方案设计充分考虑现场环境，注重布局、结构、衔接、水电、暖通等的综合考量
THE PROJECT DESIGN FULLY CONSIDERS THE SITE ENVIRONMENT AND PAYS ATTENTION TO THE COMPREHENSIVE CONSIDERATION OF LAYOUT, STRUCTURE, CONNECTION, WATER AND ELECTRICITY, HVAC, ETC.



现场严格按照设计交底图纸开展施工作业
ON SITE CONSTRUCTION SHALL BE CARRIED OUT IN STRICT ACCORDANCE WITH THE DESIGN DISCLOSURE DRAWINGS.



复合现场尺寸及其它专业预留与图纸是否有误，为工程进场做最终复核确认
CHECKING AND COMPARING THE SITE DIMENSION TO THE DRAWING, TO FINALLY CONFIRM AND ENSURE THE INSTALLATION WORK CAN BE CARRIED OUT WELL.



完善的项目经理制度、详细的项目管理规范，经验丰富的项目管理人员，对工期进度和施工质量全面管控
A COMPLETE AND SMART PROJECT MANAGEMENT SYSTEM, WITH DETAILED ITEMIZED GUIDELINES TO GUIDE THE EXPERIENCED TEAM ON THE PROCESS MANAGEMENT AND QUALITY CONTROL, TO DOUBLE ENSURE THAT THEY ACHIEVE A DESIRED OUTCOME AND MEETING THE DEADLINE GIVEN.

PART 4

HOSPITAL

CASE

/ 医院案例

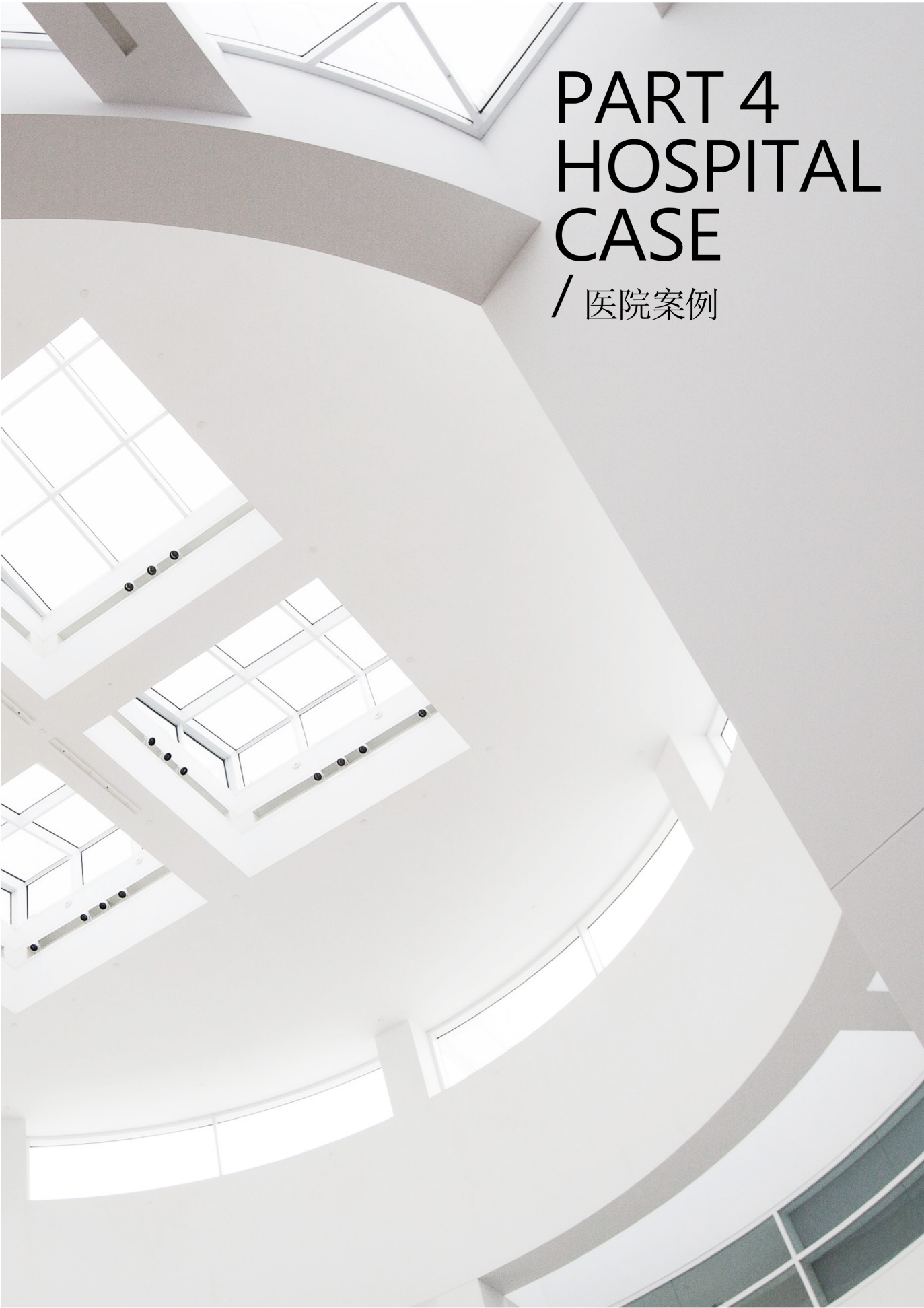

WELNEST卫勒，已为国内50余家大型三甲级医院及境外知名高端医院提供专利洗婴台，专利刷手池，定制化柜体，护士站，整装自防水卫浴空间逾50000件，打造医院大型室内装饰空间逾10个，并参建北京大学第三医院崇礼院区感染楼工程，助力2022北京冬奥会医疗保障事业



北京大学第三人民医院崇礼院区
Chongli District of the Third People's Hospital of Peking University



华中科技大学同济医学院附属同济医院
Tongji Medical College Affiliated Tongji Hospital



光谷儿童医院
Optics Valley Children's Hospital



武汉同济医院
Wuhan Tongji Hospital



南方医科大学珠江医院
Zhujiang Hospital of Southern Medical University



深圳第三人民医院
Shenzhen Third People's Hospital



广州珠江医院
Guangzhou Zhujiang Hospital



广州中山大学附属口腔医院
Dental Hospital Affiliated to Zhongshan University, Guangzhou



澳门镜湖医院
Macao Jinghu Hospital



广西口腔医院
Guangxi Stomatological Hospital



深圳禾正医院
Shenzhen Hezheng Hospital



苏州九龙医院
Suzhou Jiulong Hospital



珠海人民医院
Zhuhai People's Hospital



佛山市妇幼保健院
Foshan Maternal and Child Health Hospital



遵义五院（珠海市）
Zunyi Fifth Hospital (Zhuhai City)



中大五院（珠海市）
The Fifth Hospital of CUHK (Zhuhai City)

关 注 医 疗 环 境 创 新 材 料 运 用 共 建 绿 色 医 院

welnest[®]